

Wirbelsäulenwächter Rückenstrecker

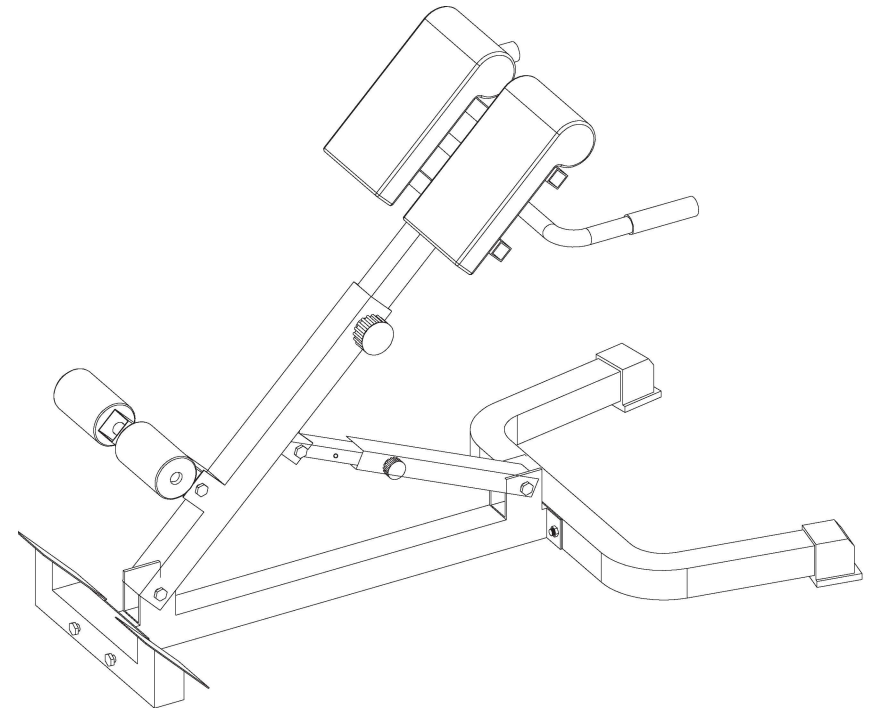

Montageanleitung

Teileliste

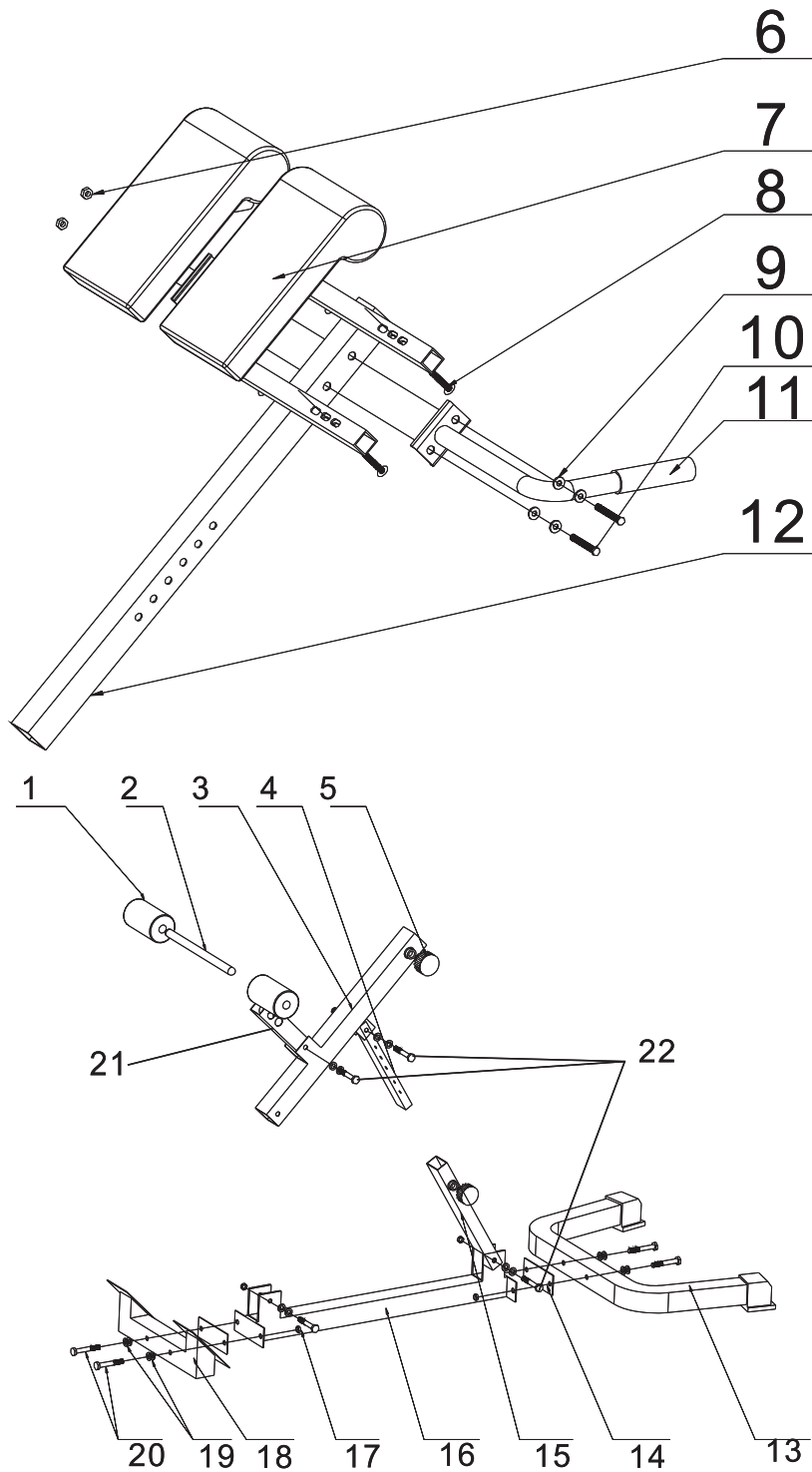

1: Schaumstoffpolster
2 Stück

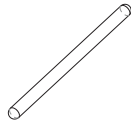

2: Polsterhalter
1 Stück

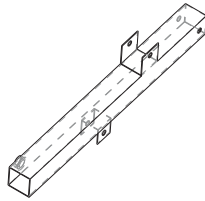

3: Haupttrahmenrohr 50mm
1 Stück

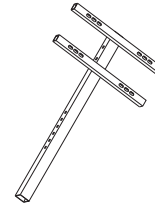

12: Verstellrohr
1 Stück

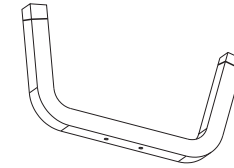

13: Vorderes unteres Rohr
1 Stück

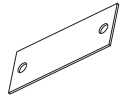

14: Stahlplatte
2 Stück

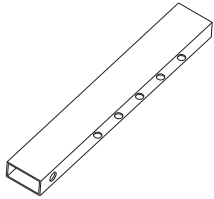

4: Stützrohr
(inneres Rohr)-1 Stück



5: Federschraubverschluss
2 Stück



6: M8 Mutter
2 Stück

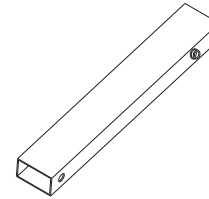

15: Stützrohr
(äußeres Rohr)-1 Stück

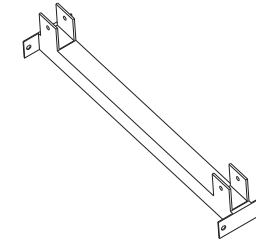

16: Haupttrahmen-Unterrohr
1 Stück



17: M10 Mutter
8 Stück

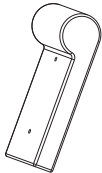

7: Polster
2 Stück

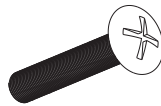

8: M8x40mm
Senkkopfschraube-4 Stück



9: M8 Unterlegscheibe
8 Stück

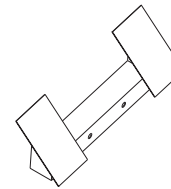

18: Hinteres unteres Rohr
1 Stück



19: M10 Unterlegscheibe
16 Stück



20: M10x70mm
Sechskantschraube 5 Stück



10: M8x55mm Sechskantschraube-2 Stück

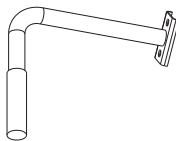

11: Linker Griff
1 Stück

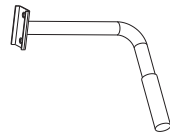

11: Rechter Griff
1 Stück

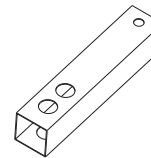

21: Fußpinch-Rohr
1 Stück



22: M10x60mm
Sechskantschraube-3 Stück